

Management system as per
执行以下标准
GB/T 19001-2016 / ISO 9001: 2015

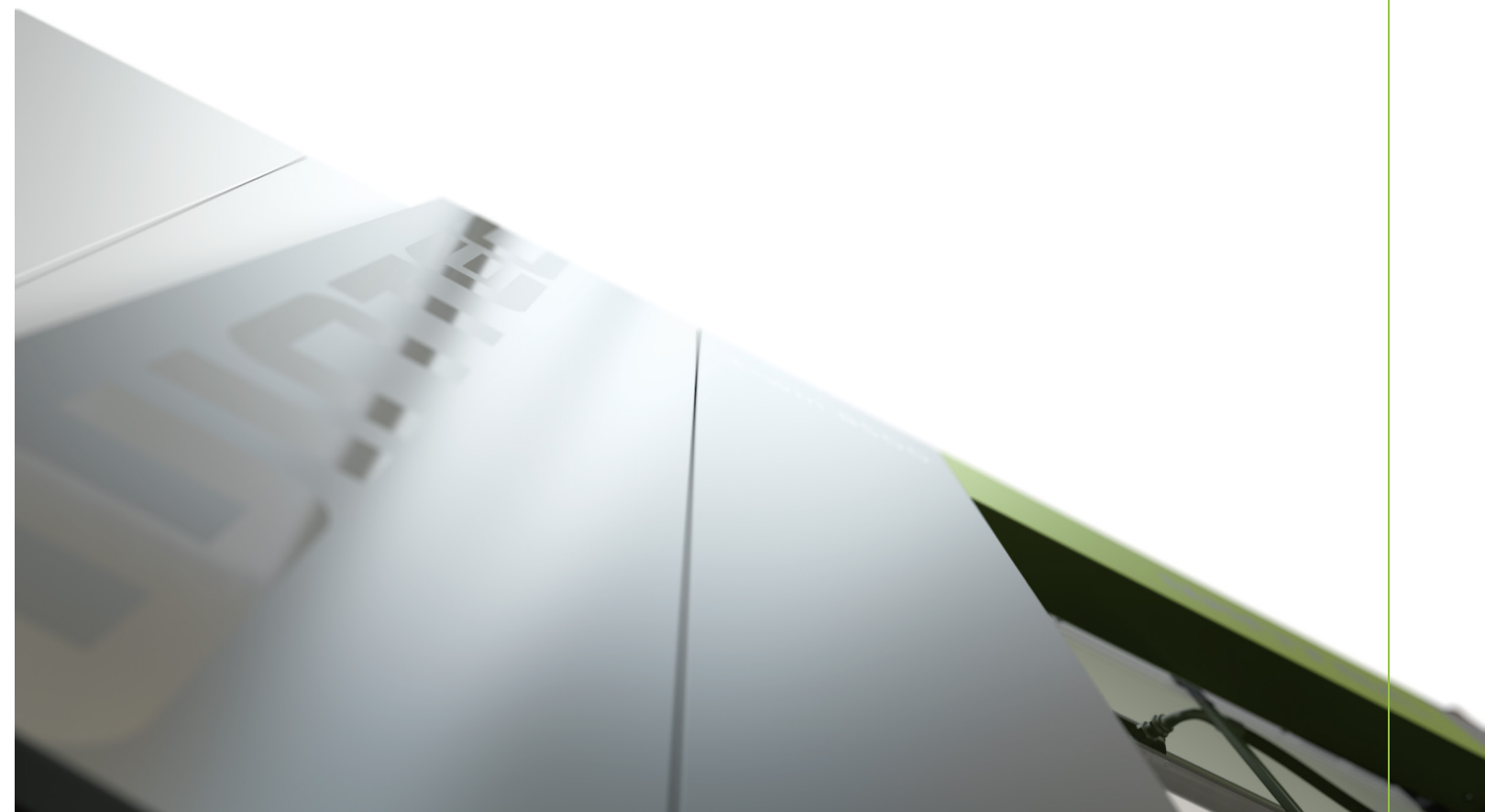

Website 网站



WeChat 微信

ENGEL MACHINERY (CHANGZHOU) CO., LTD.
No. 9 Longfan Road, Wujin National Hi-Tech Industrial Zone,
Changzhou 213166, Jiangsu Province, P.R. China
tel: +86 519 8159 5300
fax: +86 519 8159 5388
e-mail: info@wintec-machines.com

恩格尔注塑机械（常州）有限公司
中国江苏省常州市武进国家高新技术开发区龙帆路9号
邮编: 213166
电话: +86 519 8159 5300
传真: +86 519 8159 5388
邮箱: info@wintec-machines.com

www.wintec-machines.com



WINTEC, MEMBER OF THE ENGEL GROUP, offers injection molding machines for single-shot applications. The streamlined portfolio is targeted to best meet the requirements of standard plastics production. Designed and engineered in Europe, the WINTEC product lines offer great benefits of decades of expertise in injection molding: most reliable and efficient machines with an extended service life. As a 100% ENGEL owned brand, WINTEC is committed to the high quality standards of the group. Leading after sales support is guaranteed by the local service network and an in-house spare parts supply.

赢泰——恩格尔集团成员，提供适用于单色应用的注塑机。其优质的产品旨在最好地满足标准塑料制品生产的需求。在欧洲设计研发，赢泰的产品线得益于注塑行业几十年的经验：绝佳的可靠性、高效性及超长的机器寿命。作为恩格尔集团的全资子公司，赢泰忠于集团的高质量标准。广泛的服务网络、及时迅速的备件响应，确保了领先的售后支持。

WINTEC

COMMITTED TO QUALITY AND AVAILABILITY
A STRONG PARTNER NEARBY

赢泰

质量至上，可靠为先
强大的合作伙伴

WINTEC is based in Changzhou (Jiangsu Province) in China.

The local dedicated and experienced WINTEC sales team is your partner – in Asia, Middle East, Americas, Africa, Russia, and is expanding continually. We offer standard, still customized solutions to enhance your competitiveness, meanwhile focusing on what matters to you – state-of-the-art efficiency and reliability.

赢泰工厂位于中国江苏省常州市。

当地经验丰富的销售团队也是您的合作伙伴，如今赢泰销售网络已遍布亚洲、中东、美洲、非洲、俄罗斯等，并在不断拓展。为提升您的企业竞争力，我们提供标准但仍可定制的解决方案，同时，专注于您所关心的——卓越的能效及可靠性。

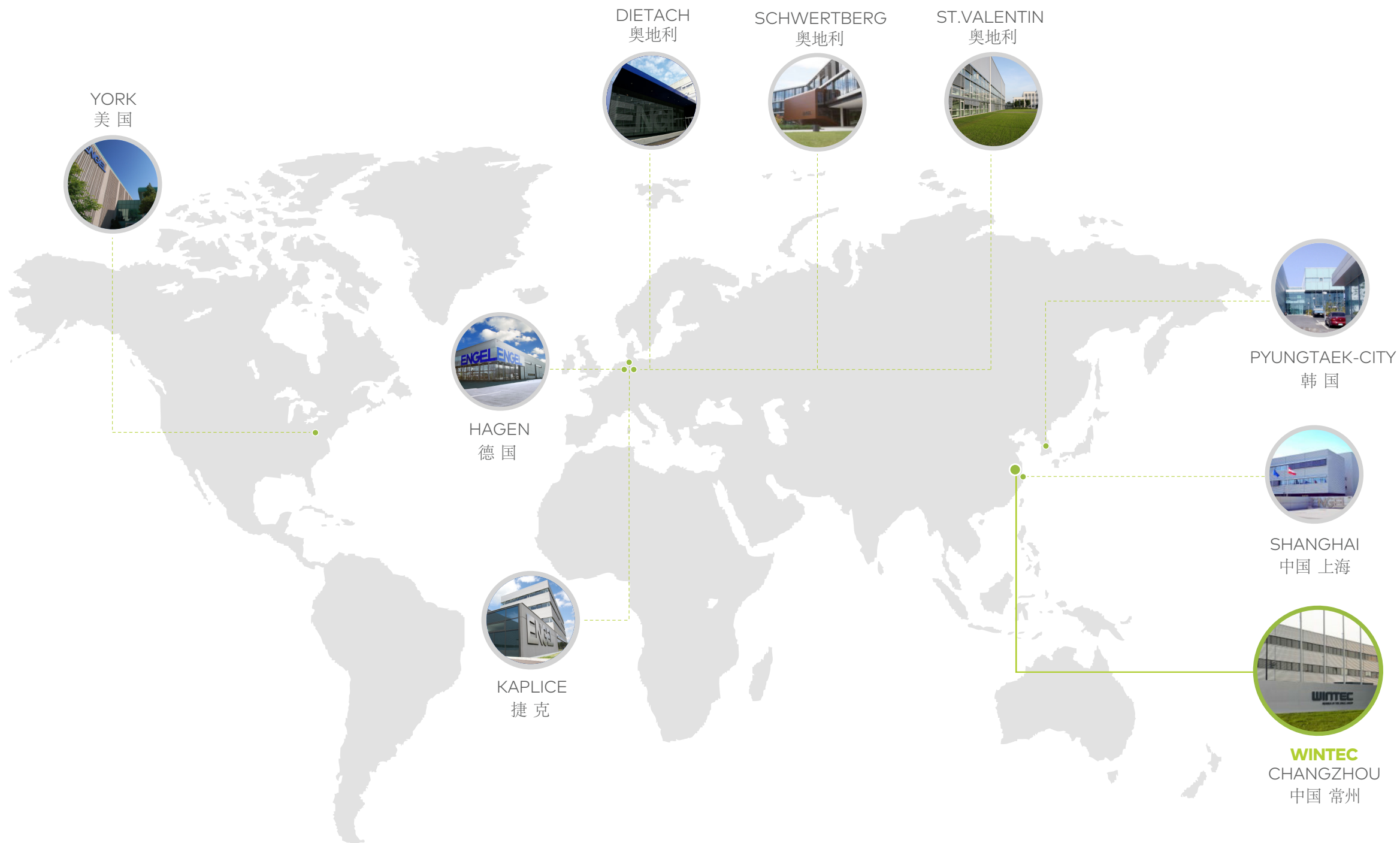

ENGEL GROUP

9 PRODUCTION PLANTS

30 SUBSIDIARIES

60 REPRESENTATIVES

恩格尔集团

9个生产工厂

30个分支机构

60个代表处

t-win

YOUR ADVANTAGES AT A GLANCE

优势一览

HIGHER PRODUCTIVITY

更高的生产效率

The servo hydraulic two-platen t-win is focused on fast and high efficient production. Fast movements, short clamping force build-up time and synchronized locking device movement reduce total cycle time and increase productivity.

伺服液压驱动二板式t-win系列注塑机专注于快速、高效的生产。高速的运动，极短的锁模力建立时间及同步锁紧装置，降低了循环周期，提高了生产效率。

SMALLER FOOTPRINT

更小的占地空间

The two-platen machine concept allows a compact design for less space requirements.

紧凑的两板式设计实现最小的占地空间。

LONGER SERVICE LIFE

更长的使用寿命

Premium components and a design concepts that reduce wear on the machine – and on your mold – guarantee an extended service life of 15 to 20 years and more.

优质的元件及优秀的设计理念，降低了机器本身乃至模具的损耗，实现15至20年甚至更长的使用寿命。

INCREASED AVAILABILITY

更高的可利用率

The reliable and proven design as well as features allow fast access for maintenance and increase machine availability and output.

可靠且久经考验的设计加之绝佳的性能，使赢泰注塑机易于维护，从而提高了机器的可利用率 and 产出。

HIGHER ENERGY EFFICIENCY

更高的能源利用率

The servo drive system servowin guarantees fast acceleration and low energy consumption.

伺服驱动系统保证了机器的快速运转，降低了能源消耗。

FASTER CONTROL UNIT

更快的控制单元

The powerful and fast-responding C2 controller with 33% higher performance than the market average ensures high output and consistent part quality.

功能强大、响应迅速的C2控制系统性能比市场平均水平高33%，保证了注塑产品的高产出及持续的高质量。

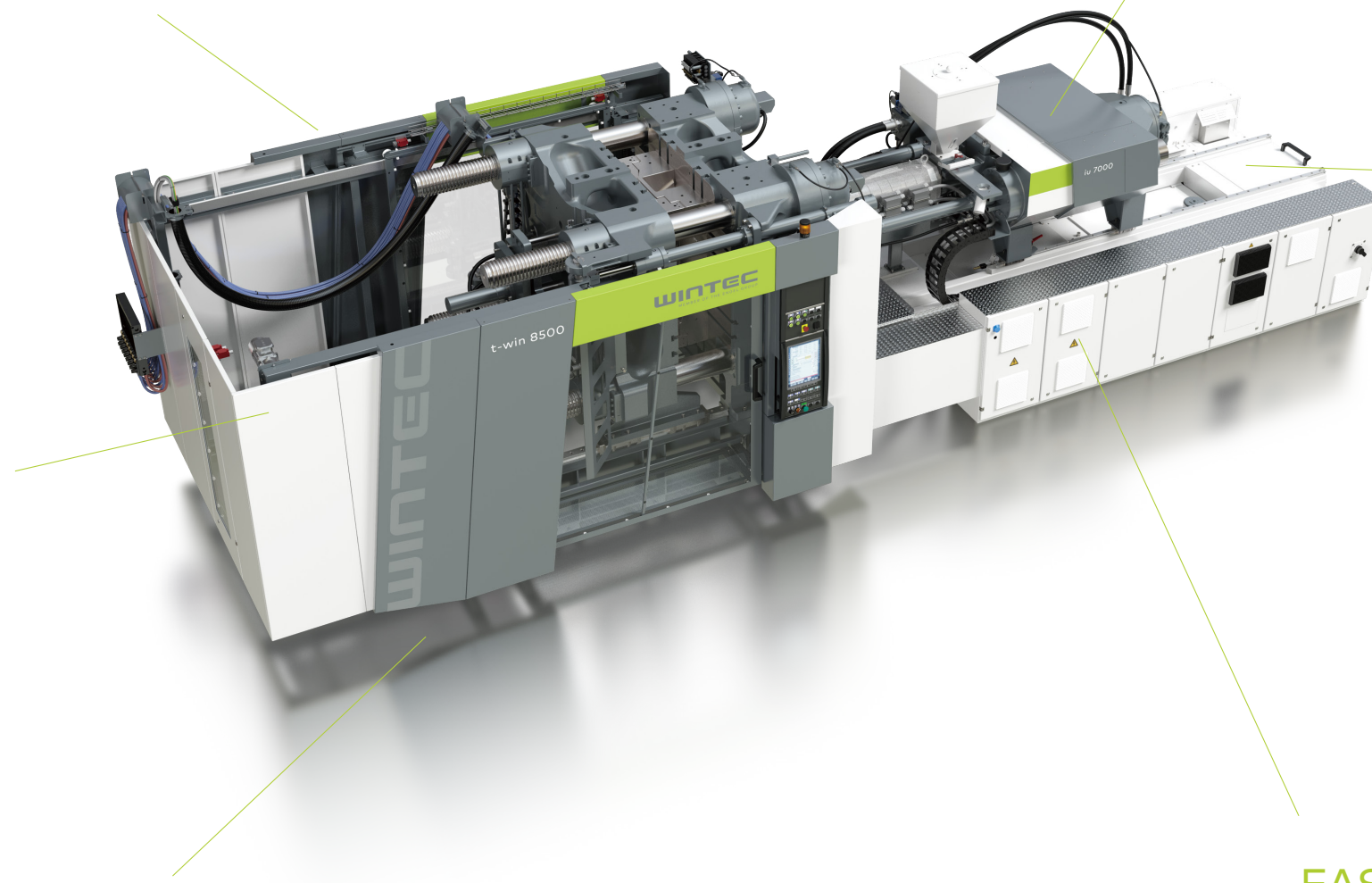

t-win Injection Unit 注射单元	2000	3300	4800	7000	11000	15000
Screw Diameter 螺杆直径 mm	55 60 70	60 70 80	70 80 90	80 90 105	90 105 120	105 120 135 150
t-win 4500						
t-win 6500						
t-win 8500						
t-win 9500						
t-win 10500						
t-win 13500						
t-win 15500						
t-win 17500						

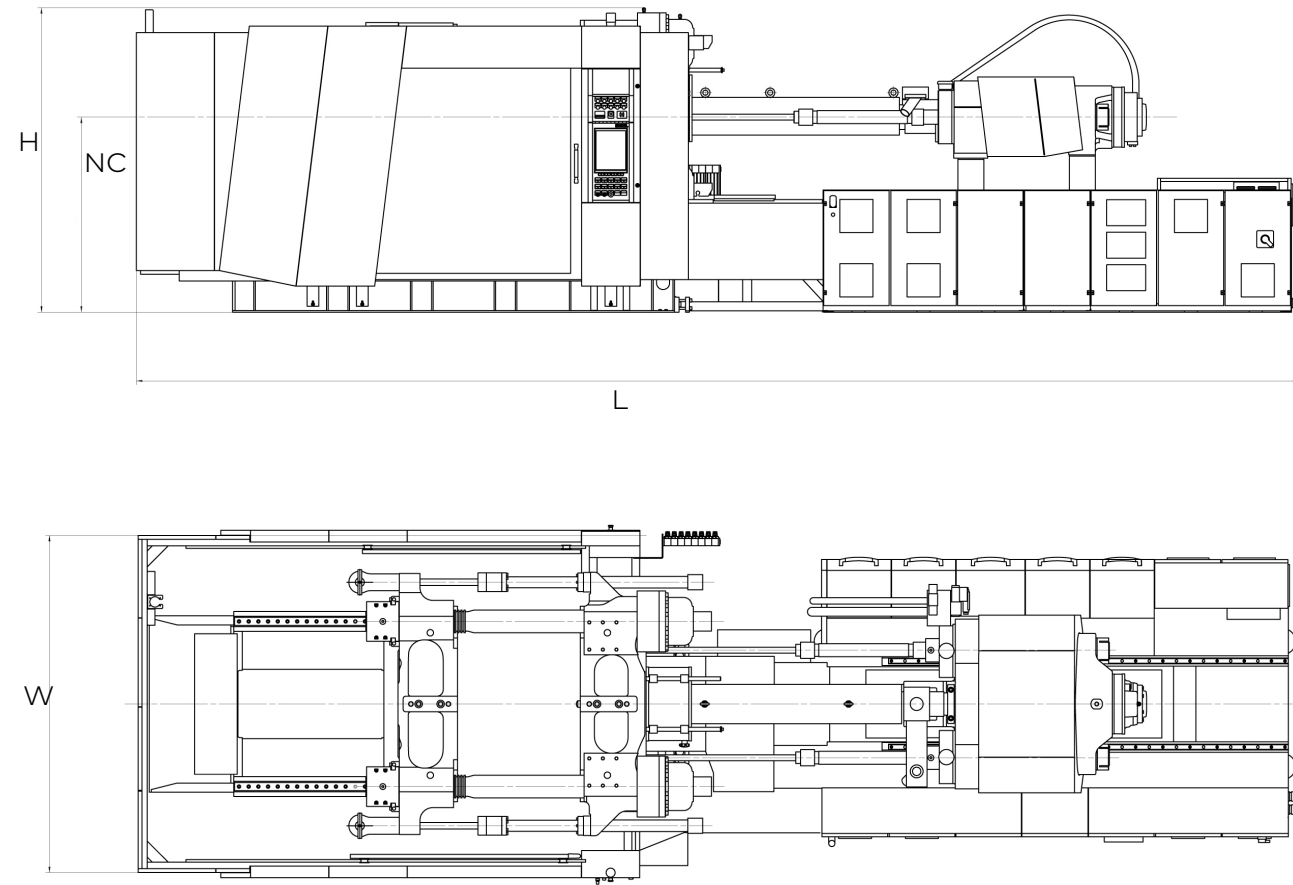

t-win Platen Dimensions 模板尺寸

4500 kN

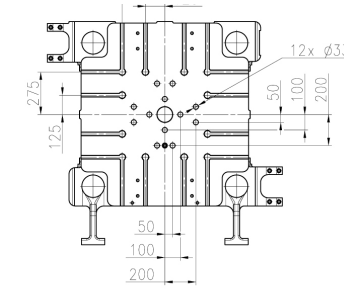

6500 kN

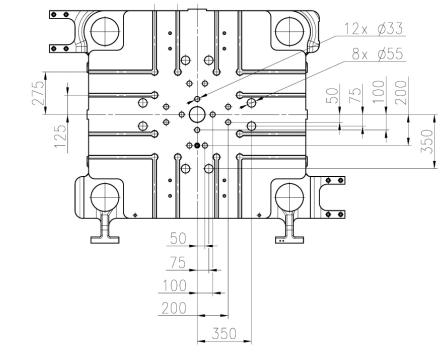

8500 kN

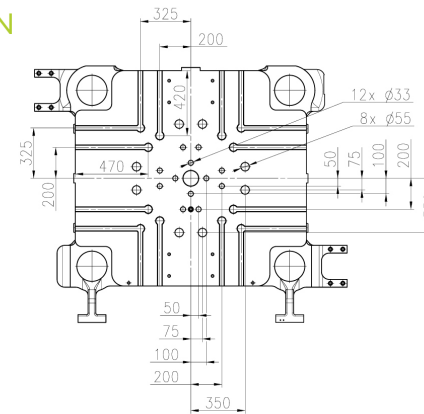

9500/10500 kN

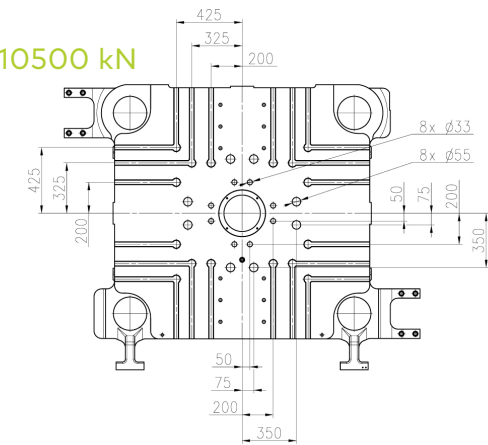

13500 kN

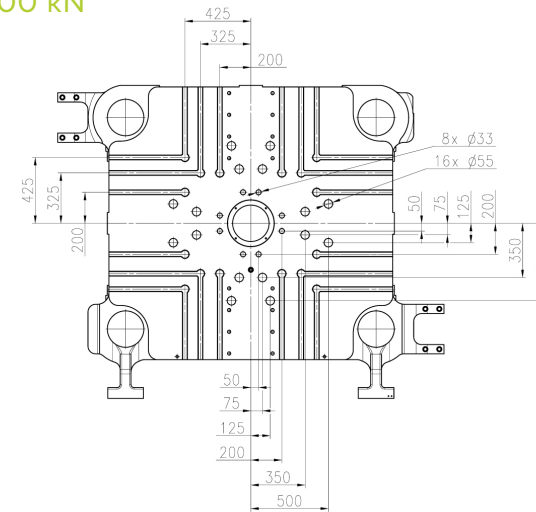

15500/17500 kN

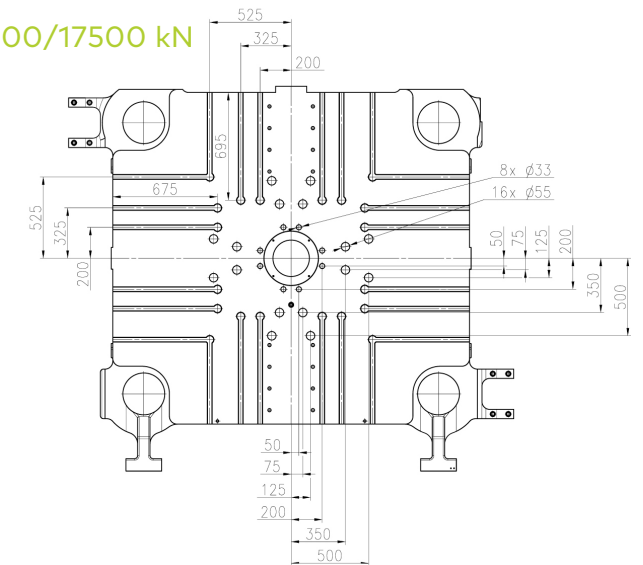

t-win Machine Dimensions 机器尺寸

			t-win 4500	t-win 6500		t-win 8500		t-win 9500/t-win 10500		t-win 13500		t-win 15500/t-win 17500	
			2000/3300	2000/3300	4800/7000	3300	4800/7000	4800/7000	11000	4800/7000	11000/15000	4800/7000	11000/15000
Length (L)	长	mm	7200	7600	8800	7700	8900	9400	10400	9800	10800	11500	
With (W)	宽	mm	2300	2700		2700		3000		3100		3600	
Height (H)	高	mm	2400	2400		2400		2600		2700		3200	
Height nozzle center (NC)	喷嘴中心高度	mm	1400	1400		1500		1500		1650		1890	

t-win Clamping Unit 锁模单元			t-win 4500	t-win 6500	t-win 8500	t-win 9500	t-win 10500	t-win 13500	t-win 15500	t-win 17500
Clamping force	锁模力	kN	4500	6500	8500	9500	10500	13500	15500	17500
Opening force with pressure pad	开模力 (高压油缸开模)	kN	260	440	510	620	620	760	1000	1000
Opening force with moving cylinder	开模力 (移模油缸开模)	kN	156	192	192	284	284	284	393	393
Opening stroke	开模行程	mm	1050	1350	1400	1600	1600	1800	2350	2350
Mold height min.	最小模厚	mm	350	400	450	500	500	600	700	700
Mold height max.	最大模厚	mm	850	950	950	1100	1100	1200	1400	1400
Total daylight max.	最大模板间距	mm	1400	1750	1850	2100	2100	2400	3050	3050
Platen size hor. x vert.	模板尺寸 (水平x垂直)	mm	1100x1190	1420x1370	1510x1440	1675x1630	1675x1630	1850x1770	2320x2180	2320x2180
Distance between tie bar hor. x vert.	拉杆间距	mm	800x800	1030x910	1100x960	1250x1100	1250x1100	1400x1150	1650x1500	1650x1500
Mold weight max.	最大模具重量	kg	6500	9500	11000	13000	13000	21000	30000	30000
Ejector stroke	顶针行程	mm	250	250	250	300	300	300	300	300
Ejector force forward/retrun	顶针力 前进/后退	kN	95/47	95/47	95/47	180/85	180/85	215/101	230/108	230/108
Dry operation (Euromap 6) time	干周期 (欧规6)	sec	3.1	3.7	4.0	4.6	4.6	5.1	5.7	5.7
Dry operation (Euromap 6) stroke	干周期开模行程 (欧规6)	mm	550	700	750	850	850	1000	1150	1150
Weight CU	锁模单元净重	t	11	16	20	30	30	39	58	58

t-win Injection Unit 注射单元			2000			3300			4800			7000			11000			15000			
Screw diameter	螺杆直径	mm	55	60	70	60	70	80	70	80	90	80	90	105	90	105	120	105	120	135	150
Screw stroke	注射行程	mm	330	350	350	360	420	430	420	480	480	480	540	550	540	630	630	630	720	730	730
Injection capacity	注射量	cm ³	784	990	1347	1018	1616	2161	1616	2413	3054	2413	3435	4762	3435	5455	7125	5455	8143	10449	12900
Screw speed	螺杆转速	min ⁻¹	220			200			160			140			120			90			
L/D ratio	长径比	L/D	22			22			22			22			22			22			
Plasticizing rate (3 zones)*	熔胶率 (三段式螺杆)*	g/s	40.0	49.9	74.2	45.3	67.5	92.4	54.0	73.9	101.8	64.7	89.1	132.7	76.4	113.7	159.5	85.3	119.6	161.4	210.8
Injection rate (regenerative)	注射速率 (低压高速)	cm ³ /s	216	257	350	243	331	432	304	397	503	372	471	641	471	641	837	693	905	1145	1414
Injection rate	注射速率 (高压低速)	cm ³ /s	188	223	304	204	277	362	258	337	426	327	414	563	388	528	690	563	735	930	1149
Injection pressure (regenerative)	注射压力 (低压高速)	bar	1990	1730	1270	1940	1690	1290	1960	1710	1350	2020	1760	1290	1900	1650	1270	1860	1450	1150	930
Injection pressure max.	注射压力 (高压低速)	bar	2300	2000	1469	2300	2000	1531	2300	2000	1580	2300	2000	1469	2300	2000	1531	2300	1800	1422	1152
Nozzle stroke	喷嘴行程	mm	600			600			800			800			800			800			
Nozzle contact pressure	喷嘴接触力	kN	110			110			150			150			150			150			
Heating wattage (incl. nozzle)	加热功率 (包括喷嘴)	kW	20	21	24	21	24	27	23	26	29	26	29	34	45	51	57	51	57	66	72
Heating zones (incl. nozzle)	加热区 (包括喷嘴)		5	6	6	6	6	6	6	6	7	6	7	7	6	6	7	6	7	7	8
Drive power	驱动功率	kW	53			53			73			90			96			115			
Oil reservoir capacity	油箱容积	l	550			550			760			760			1150			1150			
Weight IU	注射单元净重	t	5.4			6			7.1			8			13.1			14.5			

* for polystyrene 聚苯乙烯